

Outline

- Chahar bagh
- Zayande rood
 - Si-o-se pul
 - Khaju bridge





چهارباغ عباسی

Chahār Bagh.e. Abbasi
Ave.



Chahar Bagh



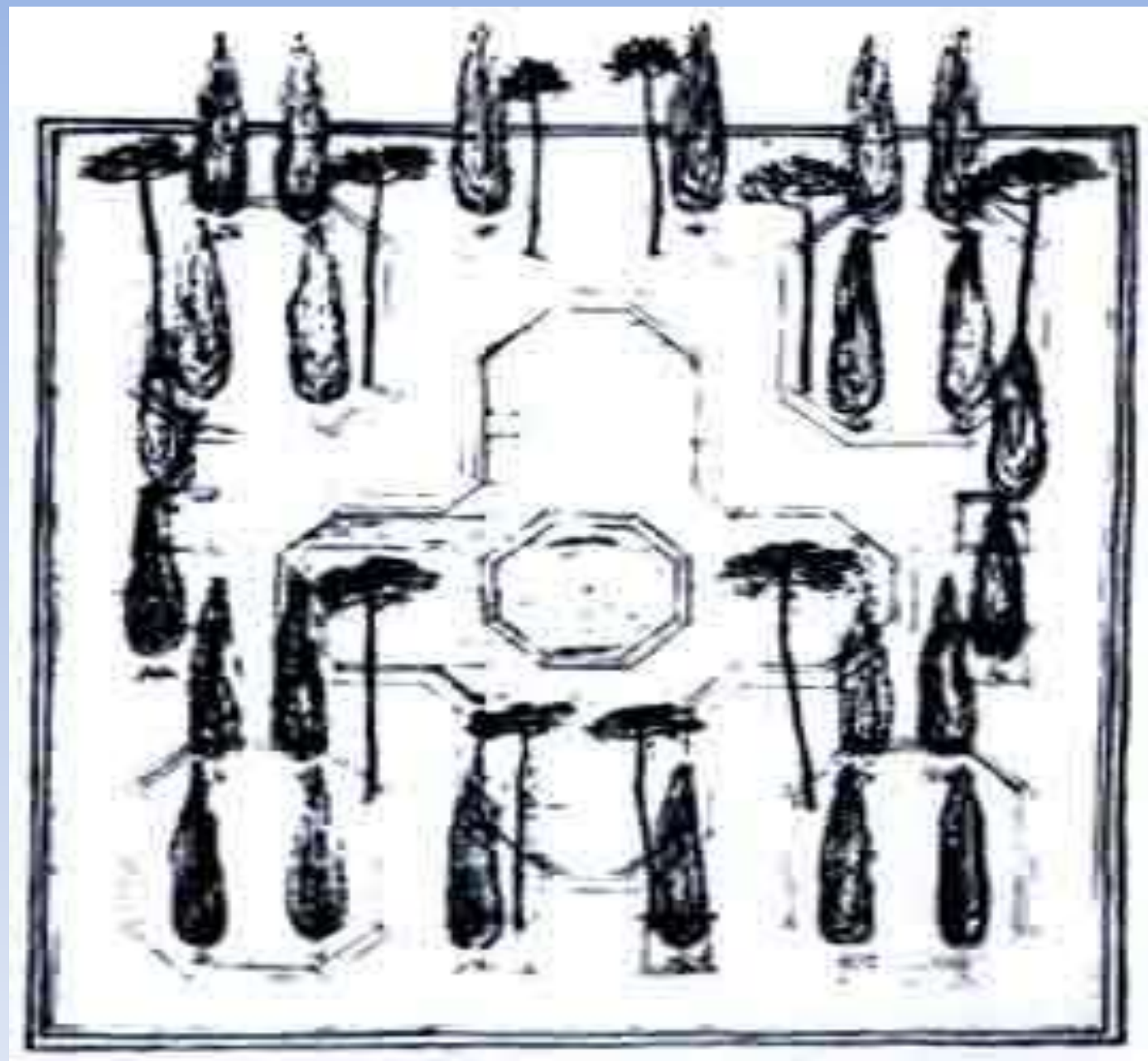

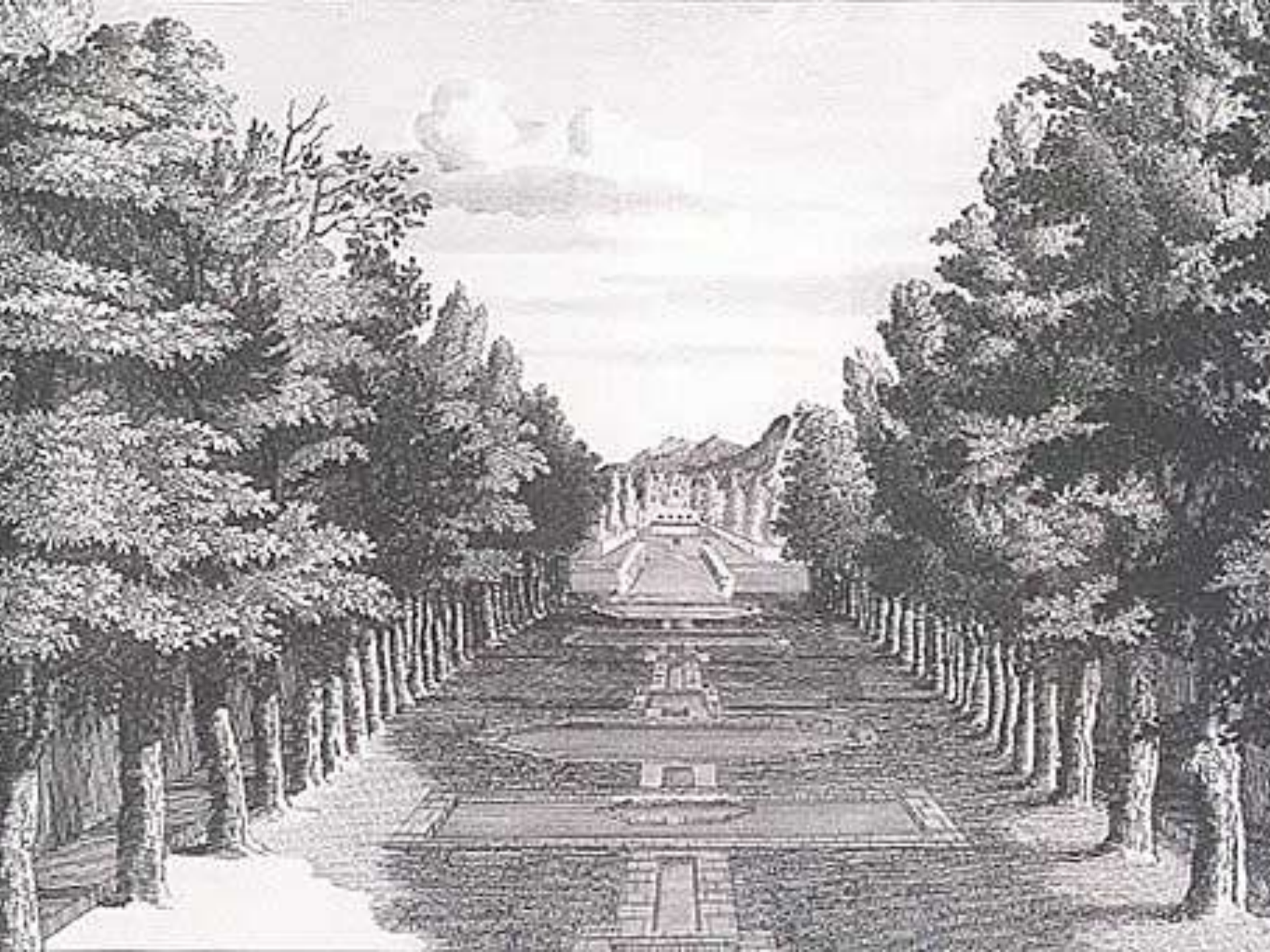





Zayande rood

- 270 km long







Si-o-se pul

- <http://www.youtube.com/watch?v=iiFkGBxKJBg>





eilinq iran







Pol-e- Khaju

- First bridge built the reign of Timurian sovereign in the 15 c
- Shah Abbas II built the present structure round about 1650
- not only a bridge but also a bam and water art structure
- Balance and Harmony



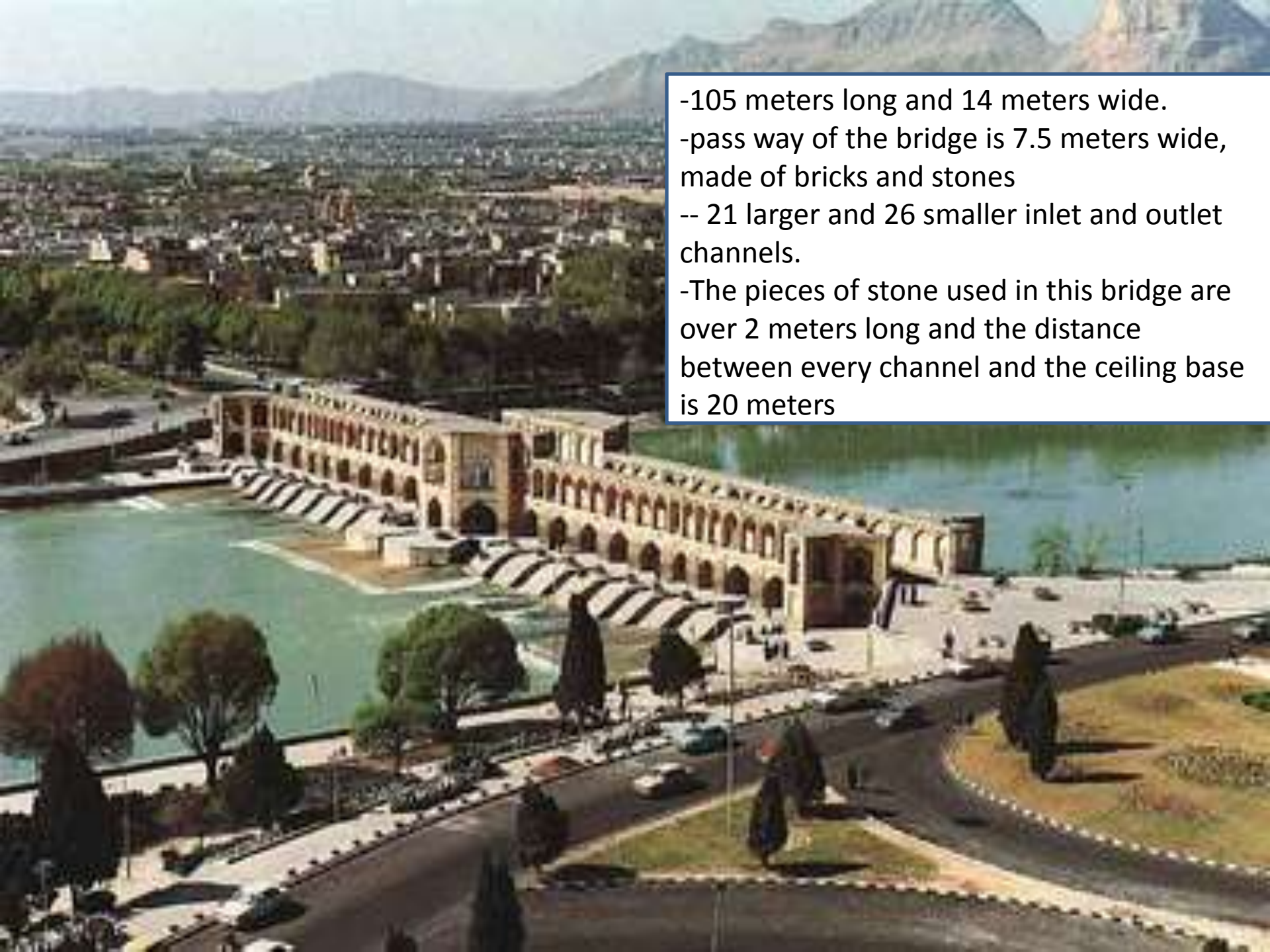

- 105 meters long and 14 meters wide.
- pass way of the bridge is 7.5 meters wide, made of bricks and stones
- 21 larger and 26 smaller inlet and outlet channels.
- The pieces of stone used in this bridge are over 2 meters long and the distance between every channel and the ceiling base is 20 meters

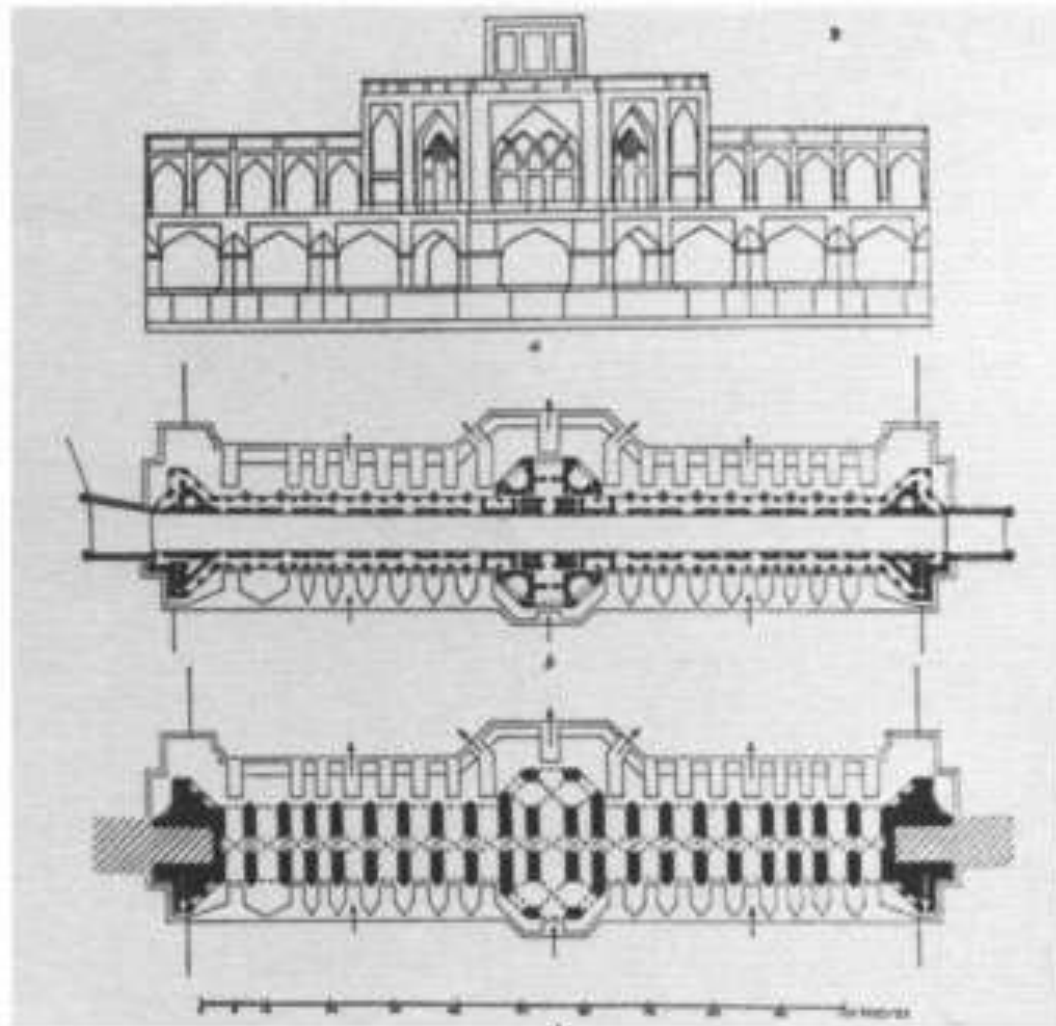

Fig. 1. Plan and elevation of the Pul-i Khwājū by Coste. After Pope, Survey.













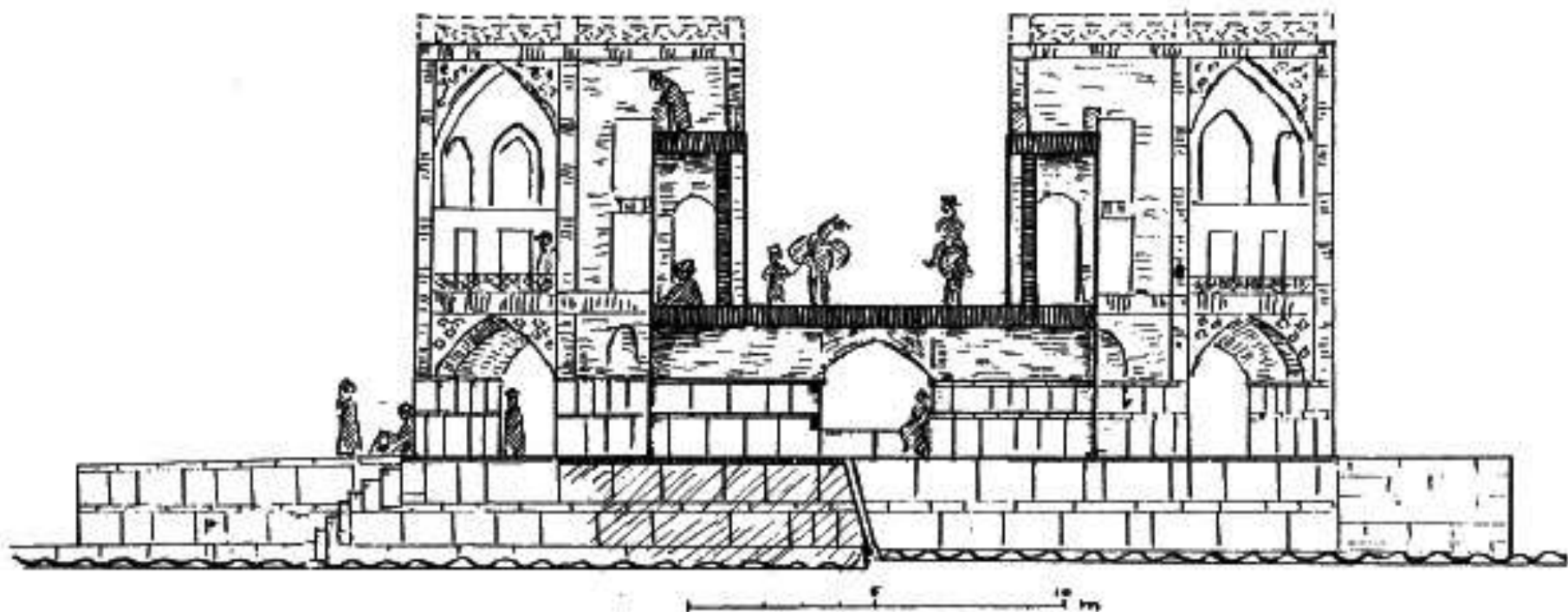

Fig. 2. Cross-section of the Pul-i Khwājū. Author's sketch with use of a drawing in Isfahan, city of light.

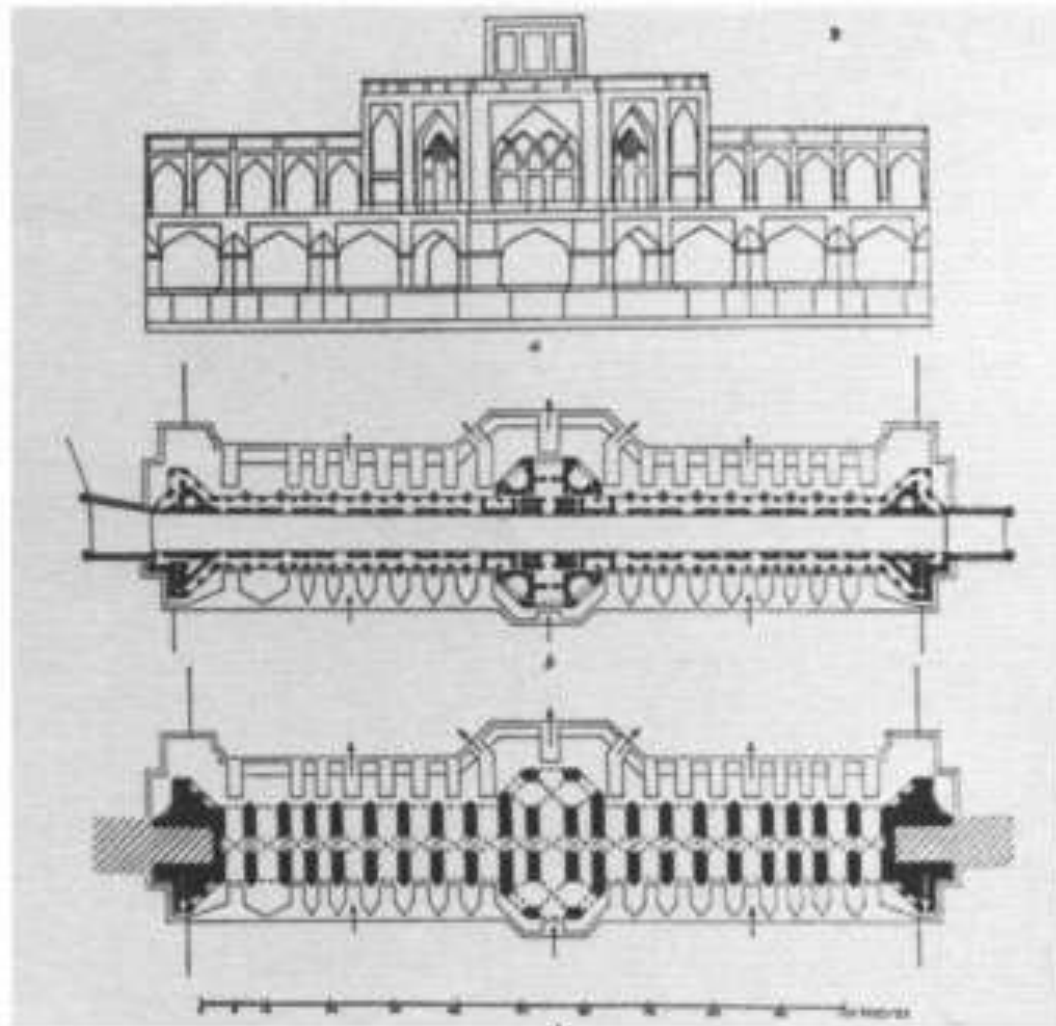
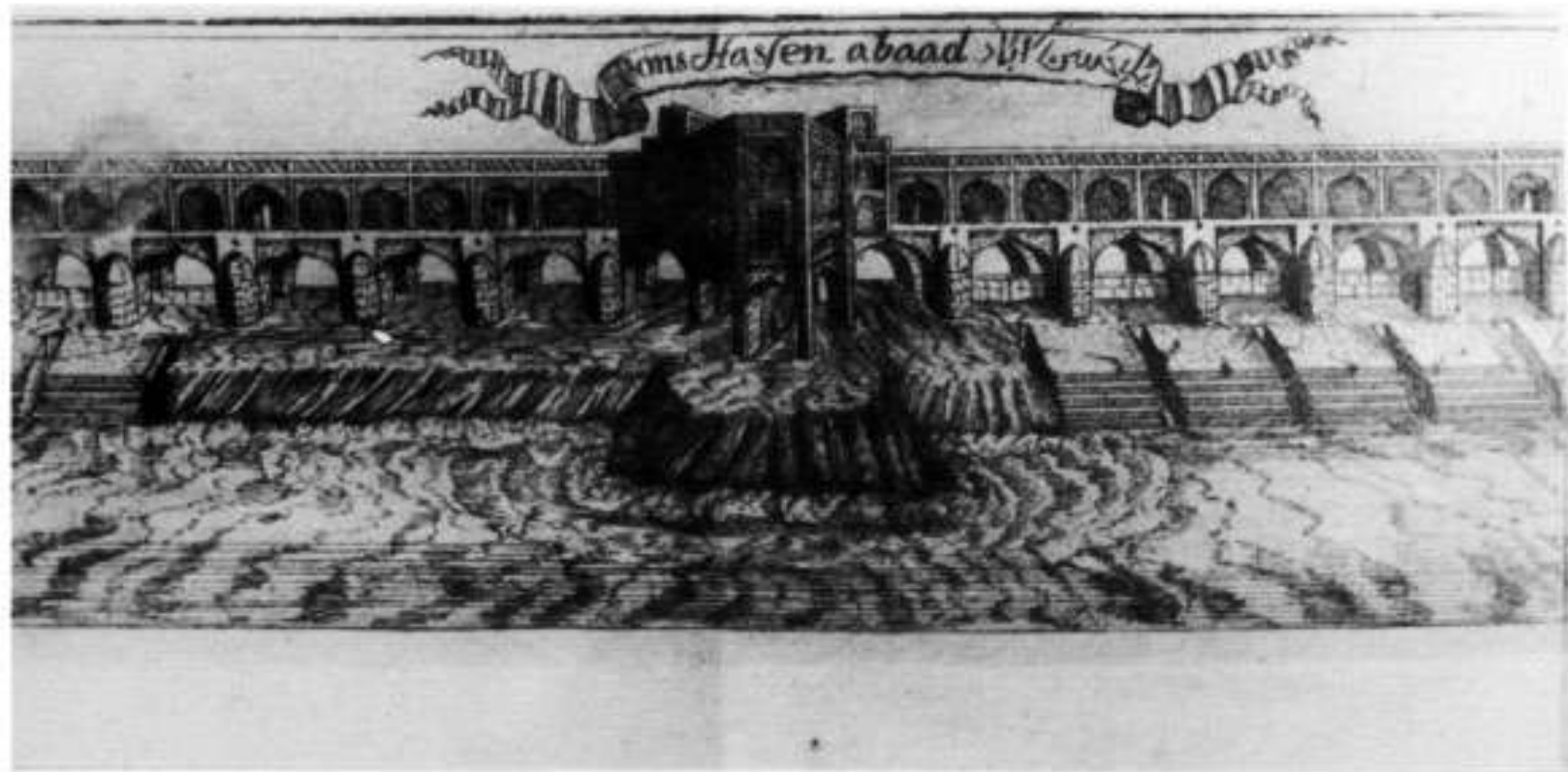

Fig. 1. Plan and elevation of the Pul-i Khwājū by Coste. After Pope, Survey.



Pl. Ia. The Pul-i Khwājū in spring 1963. Author's photograph.



Pl. Ib. The Pul-i Khwājū 1684/85. Etching in E. Kaempfer, Amoenitates exoticae, 1712.

pieces.

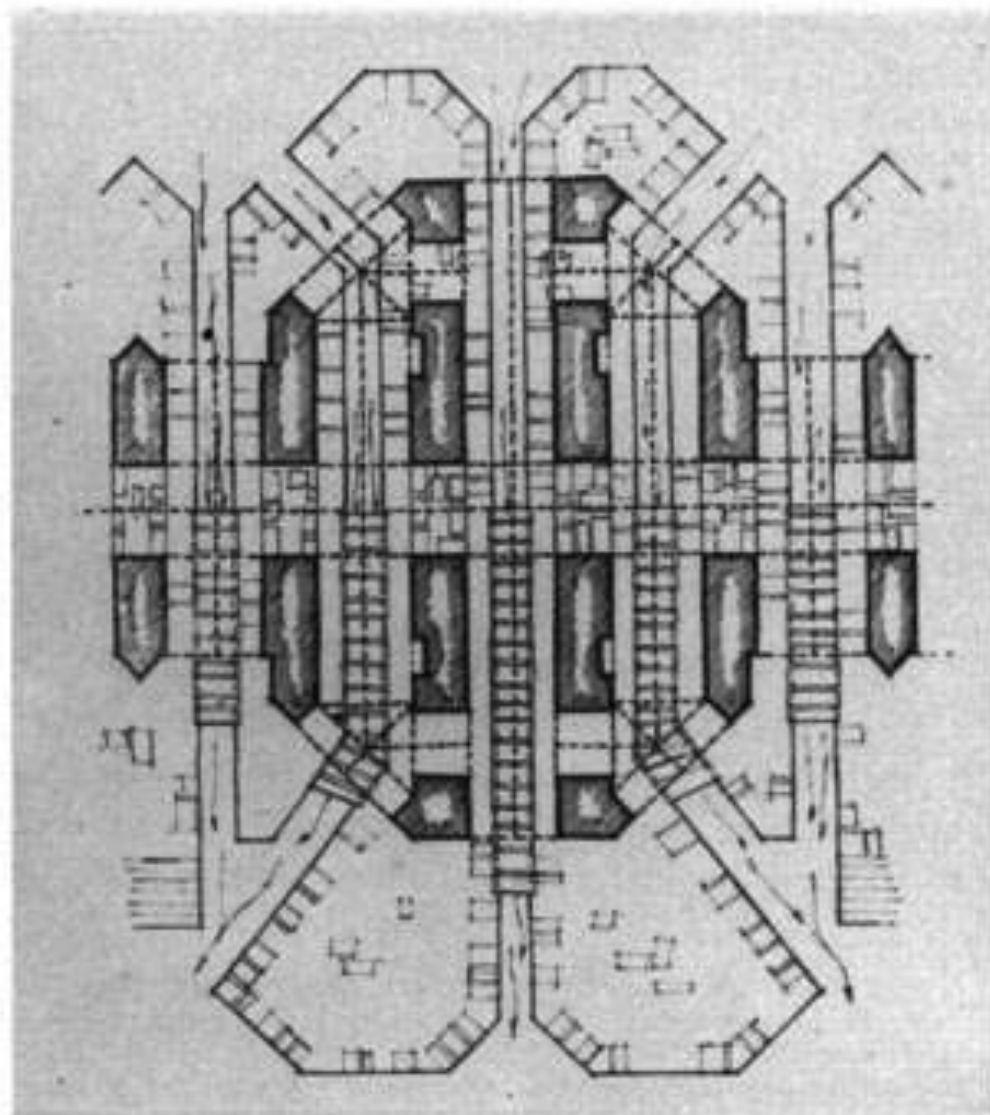

Fig. 3. Structures in the basement under the middle pavilion. Drawing by M. Ferrante.



Pl. II. The Pul-i Khavājū 1963. Author's photograph. The missing balustrade in photo-montage.



Pl. IIIa. The Pul-i Khwājū before 1938. Photograph of A. U. Pope.



Pl. IIIb. Vaults of the Pul-i Khwājū. Drawing in Jane Dieulafoy, *La Perse*, 1887.



Pl. IVa. The water art at the middle pavilion, view to the south. Author's photograph.



Pl. IVb. The water art at the middle pavilion, view to the north. Author's photograph.



Pl. Va. The Pul-i Khwājū. Author's photograph.



Pl. VIa. Water channel under the bridge with the sluice-gate.



Pl. VIb. Longitudinal view under the bridge from south to north.



P. Vb. The Sasanian bridge and dam of Shushtar. After M. Dieulafoy.